

Basic version

Pos	Qty	Part nr	Robot nr	Description		Pattern	Material
1	1	706255	R703-351-RM	Pump shaft	BWP42		AISI 304
5	1	9L0390	R750-057	Ball bearing	6310-2Z		
6	1	9L0390	R750-057	Ball bearing	6310-2Z		
10	1	706256	R704-188-GG	Seal housing	BW/BD40 BWP/BNP42	P4011	EN-GJL-250
11	1	706257	R704-192-GG	Seal housing	-2 BW40	P4012	EN-GJL-250
12	1	9D2266	R706-314	Mechanical seal	Ø35 NBR/ceramic/SiC/1.457		Carb/ceramic/NB
13	1	9D2267	R706-318	Mechanical seal	Ø30 NBR / SiC / 1.4571		SiC/SiC/NBR
14	1	9D1131	R706-334	Lip seal	OBC 050.065.10-11		
15	1	706213	R707-189-GG	Bearing housing	Ø110 IEC132/180	P4016	EN-GJL-250
16	1	706206	R707-209-GG	Bearing housing cover	IEC132/180	P4001	EN-GJL-250
18	1	706246	R707-084-ST	Distance ring	IEC100-180		S235JR
35	1	706234	R716-071-RV	Oil tank			AISI 304
36	1	706210	R716-086	Filling plug			
	1	9B5320	R756-137	Plug	G 1"		PA 66
39	1	706235	R716-072	Bracket	-H		S235JR
41	2	706233	R716-043	Coupling	RIK 8x1/4"		CuZn 40
42	2	706233	R716-043	Coupling	RIK 8x1/4"		CuZn 40
43	2	9M5530	R716-031	Pipe	Ø8 L=100mm		Cu
45	2	9B4423	R754-141	Hexagon socket screw	M 6 x 20		AISI 316
46	2	9B4423	R754-141	Hexagon socket screw	M 6 x 20		AISI 316
47	2	9B4722	R758-088	Lock washer	(M 6)		AISI 316
48	2	9B3803	R755-077	Nut	M 6		AISI 316
49	1	706280	R716-091	Pipe nipple	R1/4"x100		Fe galv.
50	1	9F2502	R716-092	Socket	R1/4"		Fe galv.
51	1	9B5420	R756-139	Plug	R 1/4"		AISI 316
56	1	77256Z	R713-259-RZ	Data plate	Blanco 87x45x1		
60	1	9D1320	R751-207	O-ring	66x 3.00		NBR
66	1	9B1850	R752-006	Circlip	A 50x2		spring steel
67	1	9B1850	R752-006	Circlip	A 50x2		spring steel
68	1	9B1870	R752-033	Circlip	J110x4		spring steel
69	1	9B1835	R752-004	Circlip	A 35x1.5		spring steel
74	8	9B4454	R754-164	Hexagon socket screw	M12x 40		AISI 316
77	4	9B4451	R754-183	Hexagon socket screw	M12x 25		AISI 316
78	4	9B4451	R754-183	Hexagon socket screw	M12x 25		AISI 316
82	1	9B2332	R756-012	Key	12x 8x50		AISI 316
83	1	9B2305	R756-101	Key	6 x 6x20		AISI 316
87	4	9B4202	R757-076	Data plate rivet	2.9x6.5		AISI 316
96	1	9S0033	R906-069	Oil	Shell Tellus 32 2 ltr		
101	1	706268	R701-213-GG	Volute	RW4030-A BW20/4030	P4015	EN-GJL-250
107	1	706279	R712-161-ST	Reducer flange	R100-NW100		S235JR
	(1)		R712-214-ST	Reducer flange	R100-4" ANSI 150		
112	1	9B5310	R709-325	Plug	G 3/8"		CuZn 40
113	1	9B5310	R709-325	Plug	G 3/8"		CuZn 40
114	1	706231	R713-175	Seal ring	A 17x23x1.5 plug G3/8"		Cu
115	1	706231	R713-175	Seal ring	A 17x23x1.5 plug G3/8"		Cu

Pos	Qty	Part nr	Robot nr	Description		Pattern	Material
118	1	9D1368	R751-176	O-ring	249.3x 5.7		NBR
124	4	9B3719	R753-210	Stud bolt	M12 x 60		AISI 316
128	4	9B4456	R754-113	Hexagon socket screw	M12x 50		AISI 316
130	4	9B3806	R755-091	Nut	M12		AISI 316
131	4	9B3806	R755-091	Nut	M12		AISI 316
133	4	9B3906	R758-102	Washer	(M12)		AISI 316
134	4	9B3906	R758-102	Washer	(M12)		AISI 316
137	1	706282	R761-002	Gasket	140xØ105x2		CR
138	1	706281	R760-138	Gasket	Ø158xØ100x3		CR
140	1	W06259	R708-362-NG	Impeller	R/BW4020/40 D/BWP22/42-20/40 con30	P4010	EN-GJS-400-15
	(1)		R708-362-NG-2	Impeller	250 RW4020/40/BW con30		
	(1)		R708-362-NG-2	Impeller	240 RW4020/40/BW con30		
	(1)		R708-362-NG-2	Impeller	235 RW4020/40/BW con30		
	(1)		R708-362-NG-2	Impeller	230 RW4020/40/BW con30		
	(1)		R708-362-NG-2	Impeller	225 RW4020/40/BW con30		
	(1)		R708-362-NG-2	Impeller	220 RW4020/40/BW con30		
	(1)		R708-362-NG-2	Impeller	215 RW4020/40/BW con30		
	(1)		R708-362-NG-2	Impeller	210 RW4020/40/BW con30		
	(1)		R708-362-NG-2	Impeller	205 RW4020/40/BW con30		
	(1)		R708-362-NG-2	Impeller	200 RW4020/40/BW con30		
	(1)		R708-362-NG-1	Impeller	195 RW4020/40/BW con30		
	(1)		R708-362-NG-1	Impeller	190 RW4020/40/BW con30		
	(1)		R708-362-NG-1	Impeller	185 RW4020/40/BW con30		
	(1)		R708-362-NG-1	Impeller	180 RW4020/40/BW con30		
	(1)		R708-362-NG-1	Impeller	175 RW4020/40/BW con30		
	(1)		R708-362-NG-1	Impeller	170 RW4020/40/BW con30		
	(1)		R708-362-NG-1	Impeller	165 RW4020/40/BW con30		
	(1)		R708-362-NG-1	Impeller	160 RW4020/40/BW con30		
	(1)		R708-362-NG-1	Impeller	150 RW4020/40/BW con30		
	(1)		R708-362-NG-1	Impeller	140 RW4020/40/BW con30		
141	1	706261	R713-226-RU	Impeller hubcap	ø30xø9x4		AISI 329
145	1	706292	R754-117	Hex. sock. screw counter sunk.	M 8x 20		AISI 316
Supplement support horizontal installation							
230	1	706276	R710-398-ST	Volute support	H BW NW100 hh225		S235JR
	(1)		R710-476-ST	Volute support	H BW 4" ANSI 150 hh225		
231	1	706224	R710-402-ST	Volute support	-2 BW BWP		S235JR
232	6	9B4441 repl	R754-027	Hexagon socket screw	M10x 25		
233	(2)	9B4462	R754-102	Hexagon socket screw	M16x 30		
234	(2)	9B3907 repl	R758-084	Washer	(M16)		
235	(2)	9B3807 repl	R755-086	Nut	M16		
240	1	706236	R710-412-ST	Bearing housing support	BWP42 hh225		S235JR
	(1)	706277	R710-413-ST	Bearing housing support	40 (GP) hh225		S235JR
242	2	9B4452 repl	R754-099	Hexagon socket screw	M12x 30		
Supplement Found. plate, coupling and motor IEC132/160							
304	(1)	9T0702	R710-335	Coupling	J-Flex Spacer 110-IEC132S+M Ø 38/42		

Pos	Qty	Part nr	Robot nr	Description		Pattern	Material
304	(1)	9T0703	R710-336	Coupling	J-Flex Spacer 150-IEC160M Ø 42/42		
	(1)	9T0700	R710-337	Coupling	J-Flex Spacer 190-IEC160L Ø 42/42		
305	(1)	76231S	R710-280-ST	Foundation plate	1250x560x110		S235JR
	(1)	706293	R710-281-ST	Foundation plate	1400x625x110		S235JR
309	(1)	76210S	R710-431-ST	Protecting hood	BW40/60/ BT40/60 L=325 IEC132		S235JR
	(1)	706295	R710-436-ST	Protecting hood	BW40/60/ BT40/60 L=355 IEC160/200		S235JR
310	(8)	9B3905	R758-101	Washer	(M10)		AISI 316
	(8)	9B3906	R758-102	Washer	(M12)		AISI 316
312	(4)	9B3046	R753-208	Hexagon tap bolt	M10x 40		AISI 316
	(4)	9B3057	R753-152	Hexagon-head bolt	M12x 50		AISI 316
313	(4)	9B3805	R755-097	Nut	M10		AISI 316
	(4)	9B3806	R755-091	Nut	M12		AISI 316
314	1	9B4496	R754-199	Hexagon socket screw	M12x 60		AISI 316
400	(1)	IEC132S 5.5-4B3	R790-004	Motor	IEC132S 5.5 kW-4 voet B3		
	(1)	IEC132M 7.5-4B3	R790-005	Motor	IEC132M 7.5 kW-4 voet B3		
	(1)	IEC132M 5.5-6B3	R790-109	Motor	IEC132M 5.5KW-6 -B3		
	(1)	IEC160M 11.0-4B3	R790-006	Motor	IEC160M 11 kW-4 voet B3		
	(1)	IEC160L 15.0-4B3	R790-007	Motor	IEC160L 15 kW-4 voet B3		
	(1)		R790-051	Motor	IEC132M 4 kW-6 voet B3		
401	(2)	76211S	R710-284-ST	Motor support	IEC132 hh225		S235JR
Option: seal flushing							
10	1	76238G	R704-188-GG-F	Seal housing	BW/BD40 spoelw/flush	P4011	EN-GJL-250
250	1	76239Z	R711-175-RZ	Baffle plate	BW40/BT20/4040		AISI 316
251	1	706232	R716-029	Pipe nipple	R3/8 x 150		AISI 316
252	3	9B4420	R754-184	Hexagon socket screw	M 6 x 12		AISI 316
Option Sparepart kit							
600	1	77884E	R506-7000	Spare part kit	BW40-H/V/K BWP/BNP42		

BW4040-H
BW4030-H

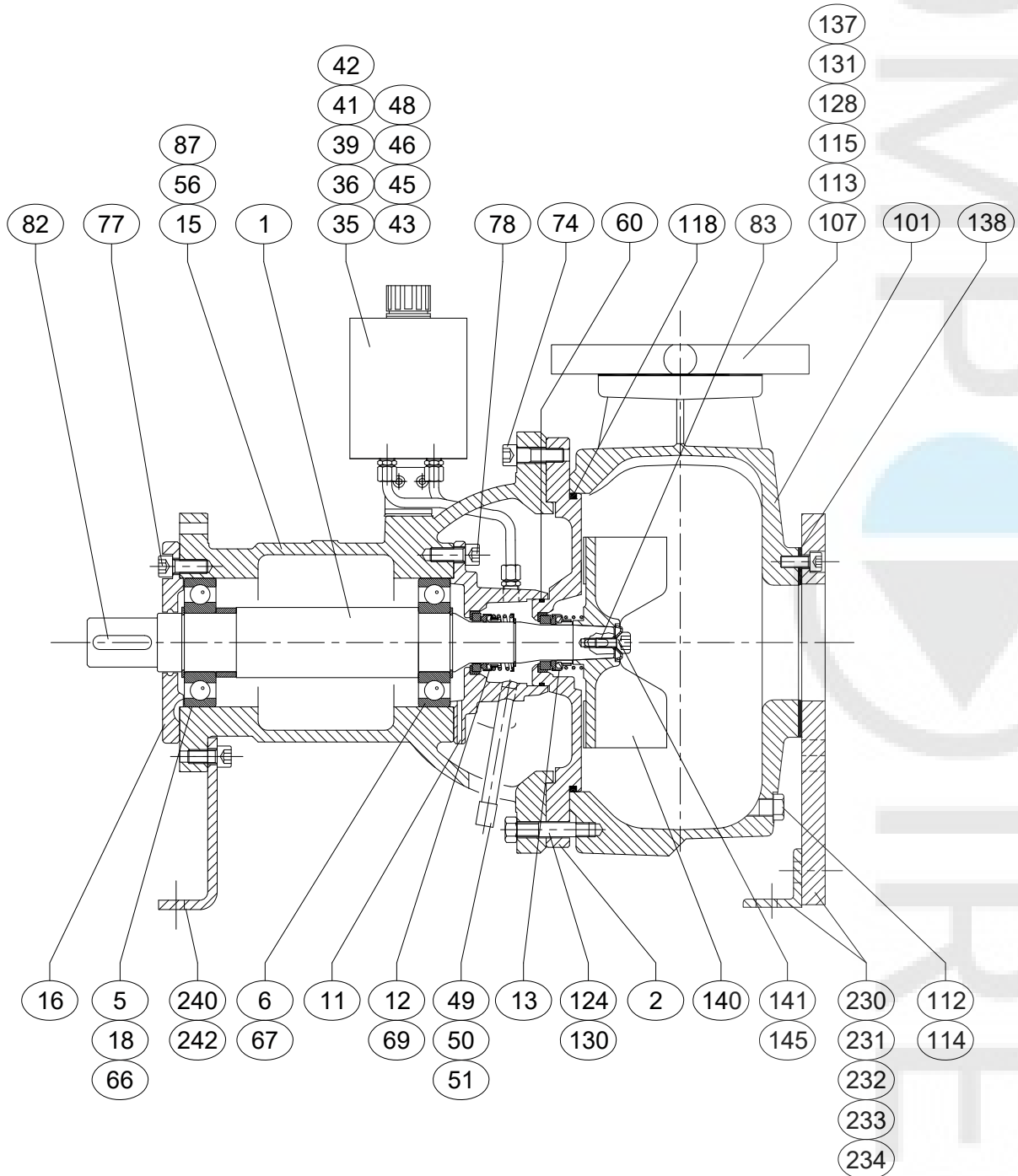

BW4040-HM
BW4030-HM

