

Basic version

Pos	Qty	Part nr	Robot nr	Description		Pattern	Material
1	1	706297	R703-352-RM	Pump shaft	IEC160/225		AISI 304
5	1	9L0390	R750-057	Ball bearing	6310-2Z		
	(1)	9L1110	R750-101	Ang. contact ball bearing	3310-2Z IEC200/225		
6	1	9L0390	R750-057	Ball bearing	6310-2Z		
10	1	706298	R704-193-GG	Seal housing	BW/BD60	P4018	EN-GJL-250
11	1	706299	R704-194-GG	Seal housing	-2 BW60	P4019	EN-GJL-250
12	1	9D2271	R706-301	Mechanical seal	Ø50 NBR/ceramic/SiC/1.457		SiC/ceramic/NBR
13	1	9D2270	R706-300	Mechanical seal	Ø50 NBR / SiC/SiC / 1.4571		SiC/SiC/NBR
14	1	9D1131	R706-334	Lip seal	OBC 050.065.10-11		
15	1	706213	R707-189-GG	Bearing housing	Ø110 IEC132/180	P4016	EN-GJL-250
16	1	706206	R707-209-GG	Bearing housing cover	IEC132/180	P4001	EN-GJL-250
18	1	706246	R707-084-ST	Distance ring	IEC100-180		S235JR
35	1	706234	R716-071-RV	Oil tank			AISI 304
36	1	706210	R716-086	Filling plug			
	1	9B5320	R756-137	Plug	G 1"		PA 66
39	1	706235	R716-072	Bracket	-H		S235JR
41	2	706233	R716-043	Coupling	RIK 8x1/4"		CuZn 40
42	2	706233	R716-043	Coupling	RIK 8x1/4"		CuZn 40
43	2	9M5530	R716-031	Pipe	Ø8 L=100mm		Cu
45	2	9B4423	R754-141	Hexagon socket screw	M 6 x 20		AISI 316
46	2	9B4423	R754-141	Hexagon socket screw	M 6 x 20		AISI 316
47	2	9B4722	R758-088	Lock washer	(M 6)		AISI 316
48	2	9B3803	R755-077	Nut	M 6		AISI 316
49	1	706280	R716-091	Pipe nipple	R1/4"x100		Fe galv.
50	1	9F2502	R716-092	Socket	R1/4"		Fe galv.
51	1	9B5420	R756-139	Plug	R 1/4"		AISI 316
56	1	77256Z	R713-259-RZ	Data plate	Blanco 87x45x1		
60	1	9D1335	R751-032	O-ring	104.5x 3.00		NBR
66	1	9B1850	R752-006	Circlip	A 50x2		spring steel
67	1	9B1850	R752-006	Circlip	A 50x2		spring steel
68	1	9B1870	R752-033	Circlip	J110x4		spring steel
69	1	9B1850	R752-006	Circlip	A 50x2		spring steel
74	8	9B4455	R754-170	Hexagon socket screw	M12x 45		AISI 316
77	4	9B4451	R754-183	Hexagon socket screw	M12x 25		AISI 316
78	4	9B4454	R754-164	Hexagon socket screw	M12x 40		AISI 316
82	1	9B2332	R756-012	Key	12x 8x50		AISI 316
83	1	9B2316	R756-125	Key	10x 8x30		AISI 316
87	4	9B4202	R757-076	Data plate rivet	2.9x6.5		AISI 316
96	1	9S0033	R906-069	Oil	Shell Tellus 32 2 ltr		
101	1	76123G	R701-178-GG	Volute	RW6132-F/A BWP62-32	P501G	EN-GJL-250
107	1	706279	R712-161-ST	Reducer flange	R100-NW100		S235JR
	(1)		R712-214-ST	Reducer flange	R100-4" ANSI 150		
112	1	9B5310	R709-325	Plug	G 3/8"		CuZn 40
113	1	9B5310	R709-325	Plug	G 3/8"		CuZn 40
114	1	706231	R713-175	Seal ring	A 17x23x1.5 plug G3/8"		Cu

Pos	Qty	Part nr	Robot nr	Description		Pattern	Material
115	1	706231	R713-175	Seal ring	A 17x23x1.5 plug G3/8"		Cu
118	1	9D1384	R751-122	O-ring	345x 5.00		NBR
124	8	9B4459	R754-192	Hexagon socket screw	M16x 45		AISI 316
128	4	9B4455	R754-170	Hexagon socket screw	M12x 45		AISI 316
131	4	9B3806	R755-091	Nut	M12		AISI 316
137	1	706282	R761-002	Gasket	140xØ105x2		CR
138	1	706281	R760-138	Gasket	Ø158xØ100x3		CR
140	1	W06155	R708-358-NG	Impeller	DWP62-30/32 con50		EN-GJS-400-15
	(1)		R708-358-NG-2	Impeller	252 RW6132/BW6030 con50		
	(1)		R708-358-NG-2	Impeller	242 RW6132/BW6030 con50		
	(1)		R708-358-NG-2	Impeller	240 RW6132/BW6030 con50		
	(1)		R708-358-NG-2	Impeller	230 RW6132/BW6030 con50		
	(1)		R708-358-NG-2	Impeller	220 RW6132/BW6030 con50		
	(1)		R708-358-NG-2	Impeller	210 RW6132/BW6030 con50		
	(1)		R708-358-NG-2	Impeller	200 RW6132/BW6030 con50		
	(1)		R708-358-NG-1	Impeller	190 RW6132/BW6030 con50		
	(1)		R708-358-NG-1	Impeller	187 RW6132/BW6030 con50		
	(1)		R708-358-NG-1	Impeller	180 RW6132/BW6030 con50		
	(1)		R708-358-NG-1	Impeller	178 RW6132/BW6030 con50		
	(1)		R708-358-NG-1	Impeller	175 RW6132/BW6030 con50		
	(1)		R708-358-NG-1	Impeller	170 RW6132/BW6030 con50		
	(1)		R708-358-NG-1	Impeller	160 RW6132/BW6030 con50		
	(1)		R708-358-NG-1	Impeller	155 RW6132/BW6030 con50		
	(1)		R708-358-NG-1	Impeller	145 RW6132/BW6030 con50		
	(1)		R708-358-NG-1	Impeller	140 RW6132/BW6030 con50		
141	1	706305	R713-160-RZ	Impeller hubcap	Ø44x13.5x8		AISI 316
145	1	9B3554	R754-180	Hex. sock. screw counter sunk.	M12x 40		AISI 316
<b>Supplement support horizontal installation</b>							
230	1	76422S	R710-414-ST	Volute support	H NW100 hh280		S235JR
231	1	706224	R710-402-ST	Volute support	-2 BW BWP		S235JR
232	3	9B4441 repl	R754-027	Hexagon socket screw	M10x 25		
233	2	9B4462	R754-102	Hexagon socket screw	M16x 30		
234	2	9B3907 repl	R758-084	Washer	(M16)		
235	2	9B3807 repl	R755-086	Nut	M16		
236	4	9B4453 repl	R754-080	Hexagon socket screw	M12x 35		
240	1	706225	R710-407-ST	Bearing housing support	40 hh280		S235JR
	(1)	706226	R710-411-ST	Bearing housing support	40/60/62 (GP) hh280		S235JR
242	2	9B4451	R754-183	Hexagon socket screw	M12x 25		AISI 316
<b>Option: seal flushing</b>							
10	1	76447G	R704-193-GG-F	Seal housing	BW/BD60 spoelw/flushing	P4018	EN-GJL-250
250	1	76448Z	R711-180-RD	Baffle plate	BW60 BWP62		AISI 316
251	1	706232	R716-029	Pipe nipple	R3/8 x 150		AISI 316
252	3	9B4420	R754-184	Hexagon socket screw	M 6 x 12		AISI 316
<b>Supplement Found. plate, coupling and motor IEC160/180-2pole</b>							
304	(1)	9T0703	R710-336	Coupling	J-Flex Spacer 150-IEC160M Ø 42/42		

Pos	Qty	Part nr	Robot nr	Description	Pattern	Material
304	(1)	9T0700	R710-337	Coupling	J-Flex Spacer 190-IEC160L Ø 42/42	
	(1)	9T0707	R710-338	Coupling	J-Flex Spacer 225-IEC180M+L Ø 42/48	
308	1	706293	R710-281-ST	Foundation plate	1400x625x110	S235JR
309	1	706295	R710-436-ST	Protecting hood	BW40/60/ BT40/60 L=355 IEC160/200	S235JR
310	8	9B3906	R758-102	Washer	(M12)	AISI 316
312	4	9B3055	R753-101	Hexagon tap bolt	M12x 40	AISI 316
313	4	9B3806	R755-091	Nut	M12	AISI 316
314	1	9B4496	R754-199	Hexagon socket screw	M12x 60	AISI 316
400	(1)	IEC160M 15-2B3	R790-011	Motor	IEC160M 15kW-2 voet B3	
	(1)	IEC160L 18.5-2B3	R790-012	Motor	IEC160L 18.5 kW-2 voet B3	
	(1)	IEC180M 22-2B3	R790-013	Motor	IEC180M 22 kW-2 voet B3	
<b>Supplement Found. plate, coupling and motor IEC200-2pole</b>						
304	1	9T0701	R710-345	Coupling	J-Flex Spacer 225-IEC200/225- 2 Ø 55/42	
305	1	706323	R710-282-ST	Foundation plate	1600x675x110	S235JR
309	1	706295	R710-436-ST	Protecting hood	BW40/60/ BT40/60 L=355 IEC160/200	S235JR
310	8	9B3907	R758-103	Washer	(M16)	AISI 316
312	4	9B3130	R753-230	Hexagon-head bolt	M16x 65	AISI 316
313	4	9B3807	R755-093	Nut	M16	AISI 316
314	1	9B4496	R754-199	Hexagon socket screw	M12x 60	AISI 316
400	(1)	IEC200L 37-2B3	R790-052	Motor	IEC200L 37kW-2 voet B3	
<b>Supplement Found. plate, coupling and motor IEC225-2pole</b>						
304	1	9T0701	R710-345	Coupling	J-Flex Spacer 225-IEC200/225- 2 Ø 55/42	
305	1	706323	R710-282-ST	Foundation plate	1600x675x110	S235JR
309	1	706295	R710-436-ST	Protecting hood	BW40/60/ BT40/60 L=355 IEC160/200	S235JR
310	8	9B3907	R758-103	Washer	(M16)	AISI 316
312	4	9B3130	R753-230	Hexagon-head bolt	M16x 65	AISI 316
313	4	9B3807	R755-093	Nut	M16	AISI 316
314	1	9B4496	R754-199	Hexagon socket screw	M12x 60	AISI 316
400	(1)	IEC200L 37-2B3	R790-052	Motor	IEC200L 37kW-2 voet B3	
	(1)	9T1549	R790-106-YT	Motor	IEC225M 45 kW-2 400/690V 50Hz Voet B3 incl. PTC IE3	
<b>Supplement Found. plate, coupling and motor IEC250-2pole</b>						
304	1	9T0709	R710-445	Coupling	J-Flex225-IEC225-4/6/IEC250- 2 Ø 60/42	
305	1	706323	R710-282-ST	Foundation plate	1600x675x110	S235JR
309	1	706295	R710-436-ST	Protecting hood	BW40/60/ BT40/60 L=355 IEC160/200	S235JR
310	8	9B3908	R758-100	Washer	(M20)	AISI 316
312	4	9B3141	R754-090	Hexagon socket screw	M20x 60	AISI 316
313	4	9B3808	R755-094	Nut	M20	AISI 316
314	1	9B4496	R754-199	Hexagon socket screw	M12x 60	AISI 316
401	(2)	76347S	R710-288-ST	Motor support	IEC160 hh280	S235JR
401	(2)	76348S	R710-291-ST	Motor support	IEC180 hh280	S235JR

Pos	Qty	Part nr	Robot nr	Description		Pattern	Material
401	(2)	77166S	R710-294-ST	Motor support	IEC200 hh280		S235JR
401	(2)	76349S	R710-295-ST	Motor support	IEC225 hh280		S235JR
401	(2)	76350S	R710-296-ST	Motor support	IEC250 hh280		S235JR
<b>Option: impeller in special material</b>							
140	1	76158U	R708-358-RU	Impeller	RW/BW60/6132 con50	P483U	AISI 329
<b>Option Sparepart kit</b>							
600	1		R506-7003	Spare part kit	BW6032/41 BWP/BNP62		
<b>Option Sparepart kit</b>							
600	1		R506-7004	Spare part kit	BW60 IEC200		



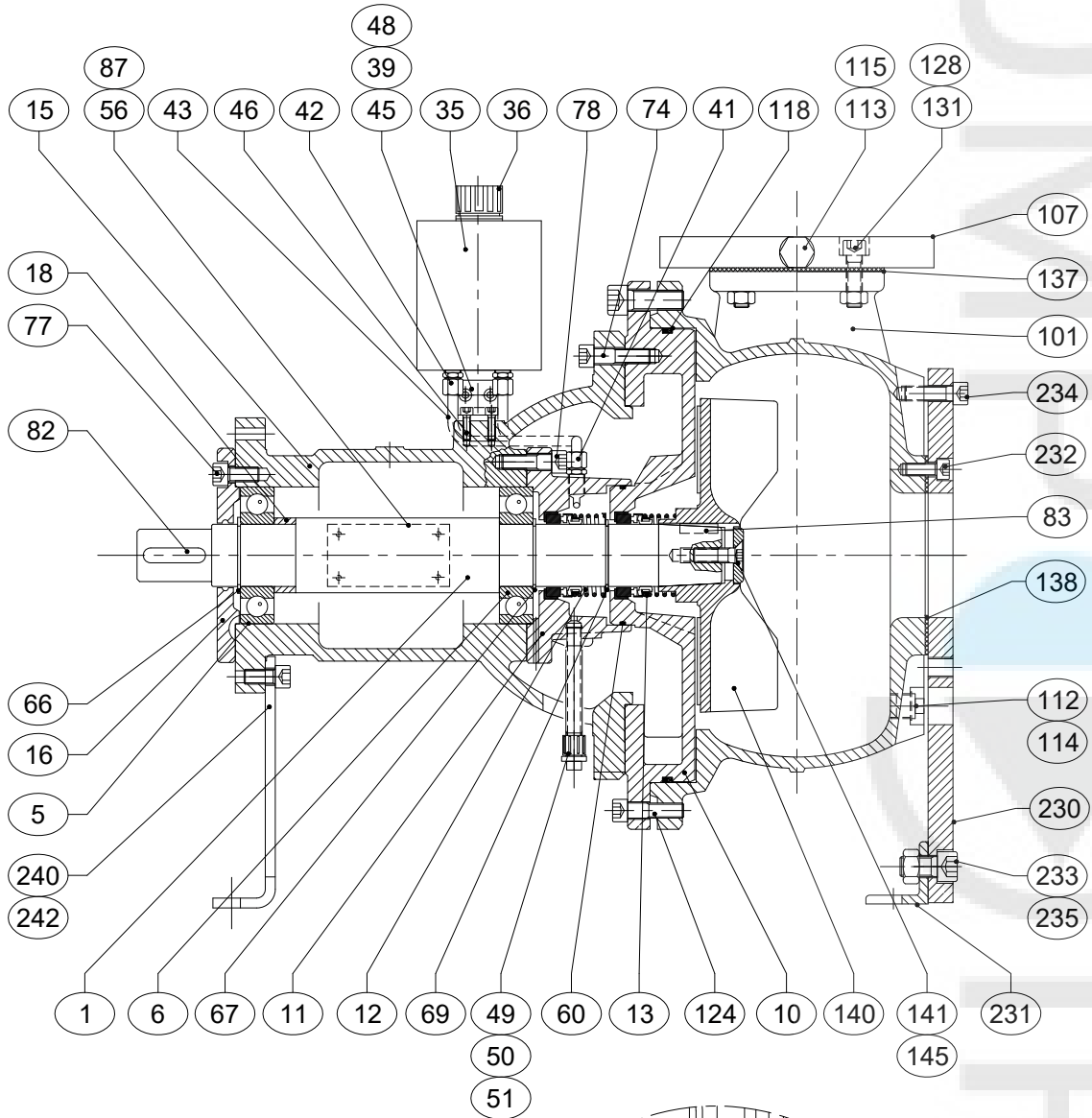

Spoeling  
Fremd Spülung  
External flushing  
Rinçage

